

## Gully Top Frame Pro



### FEATURES

- Gully top frame with integrated water strainer
- Height easily to adjust from the topside
- 4 options to connect with our drains. The ports can be broken out easily on site.
- The gully top frame can also be used separately as well as system-independent.

### DATA

- Body: Galvanised steel with super corrosion protector or stainless steel
- Dimension: 250 x 250 mm  
400 x 400 mm
- Height Adjustment: 73 - 103 mm  
93 - 143 mm  
113 - 183 mm

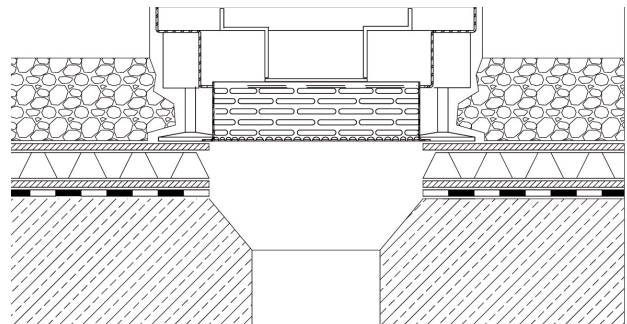

### DIMENSION ON REQUEST

- Dimension: 500 x 500 mm

### SUGGESTION FOR A TENDER

#### \_\_psc gully top frame pro

- Dimension:  250x250 mm  400x400 mm
- Raw material  galvanised steel with super-corrosion protection  stainless steel
- Grating:  mesh grid  perforated grid  flat course grating
- Adjustable height:  73-103 mm  93-143 mm  113-183 mm

Connection with drains possible on 4 sides, incl. water strainer made of stainless steel, to deliver and to install professionally

Proof of delivery: 6 fuers Gruen GmbH - Kanalstrasse 2 - D-66130 Saarbruecken  
Phone (+49) 06 81 / 9 60 21 46 - 0 - Fax (+49) 06 81 / 9 60 21 46 - 26  
E-Mail [info@6-f-g.de](mailto:info@6-f-g.de) - [www.6-f-g.de](http://www.6-f-g.de)